

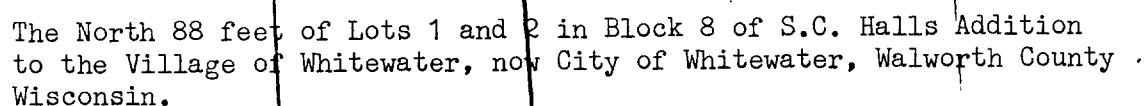

MILWAUKEE STREET



An undivided one-half interest as tenants in common with the adjoining property owner, in and to the following parcel of land: Beginning at a point 88 feet South of the Northwest corner of Lot 1, Block 8, S.C. Hall's Addition to the Village, now City, of Whitewater, and running thence East 23 feet parallel with the North line of said lot 1, thence South 23 feet parallel with the West line of said lot 1, thence West 23 feet parallel with the North line of said lot 1, thence North 23 feet along the West line of said lot 1, to the point of beginning.

Excepting a parcel of land as described in Volume 226 on page 83 of Walworth County records, in the Walworth County Register of Deeds Office, Walworth County, Wisconsin

Survey ordered by Atty. Soffa - Whitewater WI

Bearings referenced to the centerline of Milwaukee Street
assumed to Bear N 89 17'00"E

I hereby certify that I have surveyed the property described hereon and that the map shown hereon is a true and accurate representation thereof to the best of my professional knowledge and belief.

Dated this 25 day of Mar., 1988

Daniel D. Cooper
Daniel D. Cooper, RLS No. S-1464

